

MASTER PUSH PULL PROP

Length (mm)	Weight (Kg)	Product Code
590 Strut	50.0	420500
550 Strut	55.0	420550
360 Strut	55.0	420600

Aligns and anchors the formwork to the ground.



CONCRETING PLATFORM

Description	Weight (Kg)	Product Code
2.7m Platform	66.0	421010

Allows for concrete to be safely dispensed into the form.



RINGER UNI CLAMP

Description	Weight (Kg)	Product Code
Uni Clamp Galvanized	3.2	421000

Connects two formwork panels together.

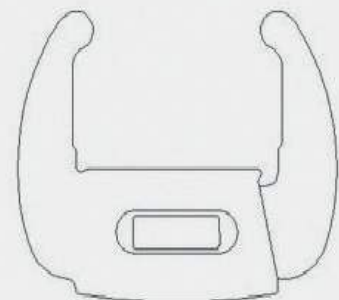

MASTER RS- CLAMP

Description	Weight (Kg)	Product Code
RS-Clamp galvanized	1.6	421004

Secures wailers to the formwork.

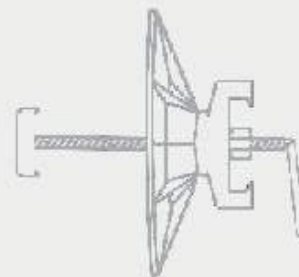

MASTER STOP END COUPLER

Description	Weight (Kg)	Product Code
Stop End Coupler	28.9	420900

Used to secure and hold the formwork at the ends.



RINGER COMBI PLATE

Description	Weight (Kg)	Product Code
15mm	1.0	420200
20mm	1.3	420100

Used in conjunction with a tie rod to secure the panels.

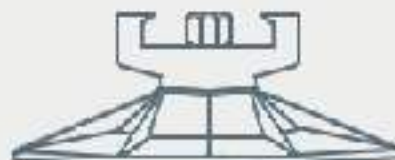

RINGER UNI FIXING BOLT

Description	Weight (Kg)	Product Code
300mm	14.9	420800

Use to fix two panels together.

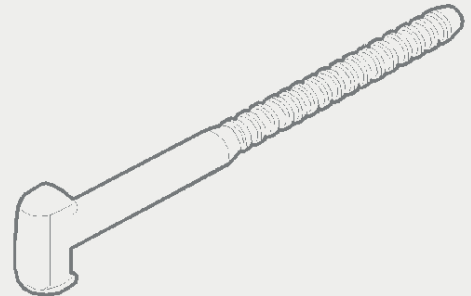

MASTER CRANE HOOK

Description	Weight (Kg)	Product Code
Lifting Hook	11.0	420701

Used to lift panels into place and remove them when stripping.

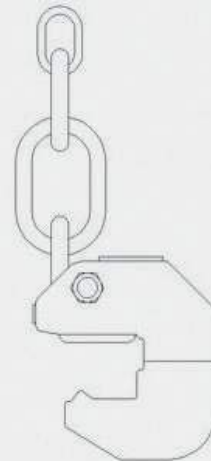

UNIVERSAL WALING

Description	Weight (Kg)	Product Code
1.5	18.7	420200
1.0	12.8	420100

Used to connect and support two panels together.



MASTER CORNER WALING

Description	Weight (Kg)	Product Code
Corner Waler galvanized	14.5	420300

Connects and support two panels meeting at a 90° angle.

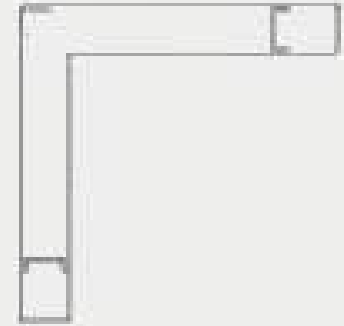

A service you can rely on

We provide a range of services to meet your formwork needs. Whether you need design, hire, sale, or transport, our expert team will provide you with a safe and reliable formwork solution for your project.

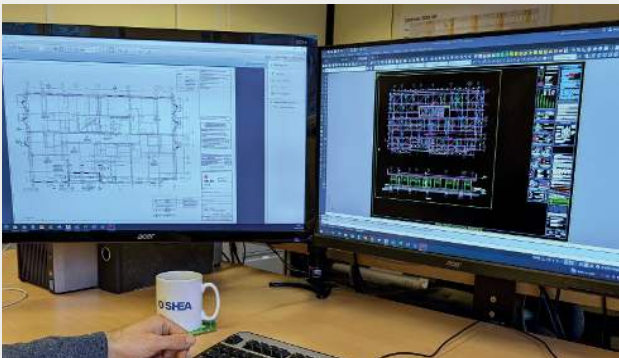

DESIGN

Our experienced team of designers can provide you with a tailored solution to your project. Their vast expertise in designing formwork structures and comprehensive knowledge of our formwork products will save you time and money, while also making sure you get the right equipment for your project.



HIRE

Our large holding ensure we always have the right product for you, whether it's a residential, commercial or infrastructure project, whilst our FORS Silver compliant fleet of HIAB-equipped vehicles ensures that equipment can be unloaded safely and efficiently, without the need for a crane or extra labour.



SALES

We also offer a broad range of formwork for sale. No matter your budget or project size, we can provide you with the best, high-quality formwork in the industry. We work closely with our supply chain to ensure you get the right equipment, customised to your preferences and requirements.



REPAIRS

We provide a thorough refurbishment, repair and cleaning service. Our 1090 EN Certified engineers can work on all formwork and falsework systems, and can extend the lifespan and efficiency of your investment.

Get in touch
today to
discuss
your project.



Find Us

O'Shea Plant Hire
Station Yard
Station Road
Smallford
AL4 0HF



Contact Us

 sales@osheaplanthire.co.uk

 01727 826 748

 www.osheaplanthire.co.uk

 <https://www.linkedin.com/company/o-shea-plant-hire/>

TERMS & CONDITIONS

Any unauthorised copying, disclosure or distribution of this brochure or any of its contents is strictly prohibited.

The information and details contained in this brochure remains the sole property of C.J. O'Shea (Plant Hire) and/or relevant external sources and is not be altered or reproduced with prior permission.

C.J O'Shea (Plant Hire) Ltd reserve the rights to change any information contained in this brochure without giving prior notice.



DISCLAIMER

The pictures, diagrams and examples used in the booklet are purely for illustration.

They are demonstration only and not be used for any other purpose.

All information is correct at the time of printing and in accordance with manufacture's technical data.